



# **ROOFTOP AND WATER TOWER**

## PRODUCT SELECTION GUIDE

## Table of Contents

Structural support solutions .....	3
Resources .....	4
<i>ANDREW distribution locations</i> .....	5
Rooftop applications .....	6
<i>High capacity single and dual penetrating rooftop frame</i> .....	7
<i>High capacity single and dual ballasted rooftop frame</i> .....	8
<i>PIM-Guard single and dual ballasted rooftop frames</i> .....	9
<i>Rooftop frames - non-penetrating</i> .....	10
<i>Rooftop frames - penetrating</i> .....	12
<i>Chimney mounts</i> .....	13
<i>Radio mounts</i> .....	14
<i>Tripod mounts</i> .....	15
<i>Universal tripod mounts</i> .....	16
<i>Parapet &amp; cube mounts</i> .....	17
<i>Wall mounting components</i> .....	18
<i>Galvanized cable support components</i> .....	20
<i>Wall cable support components</i> .....	21
Water tower .....	22
<i>Stackable water tower pod mounts</i> .....	23
<i>Water tower sector frames</i> .....	25
<i>Water tower mounts</i> .....	26
<i>Water tower cable support components</i> .....	27





## STRUCTURAL SUPPORT SOLUTIONS

ANDREW provides structural support solutions that deliver stability, durability, and precision for the most important networks in the world. Our premium structural support solutions reinforce your structure and optimize antenna performance. As a result, these solutions help you realize significant, long-term OpEx savings.

Our support systems are suited to be used on virtually any kind of tower, monopole, rooftop structure or water tower. Each solution is engineered to meet or exceed the latest EIA/TIA code requirements and conform to both ISO-9001 standards and AISC specifications. This proven excellence enables network operators to:

- Minimize or eliminate antenna misalignment
- Utilize available spectrum more efficiently
- Improve RF path integrity and overall network performance
- Increase throughput and quality of service
- Mitigate customer churn and total cost of ownership

Because our components are engineered and manufactured to the highest standards and most exact specifications, you can rest assured they've been designed to fit snugly on your tower and fabricated to withstand the harshest elements. Whether you need additional U-bolts for your mount, or struts and brackets for your microwave, pipe or stand-off mounts, we deliver the most durable mounting components to keep your antenna properly aligned.

## RESOURCES

Where to buy

Key ANDREW locations



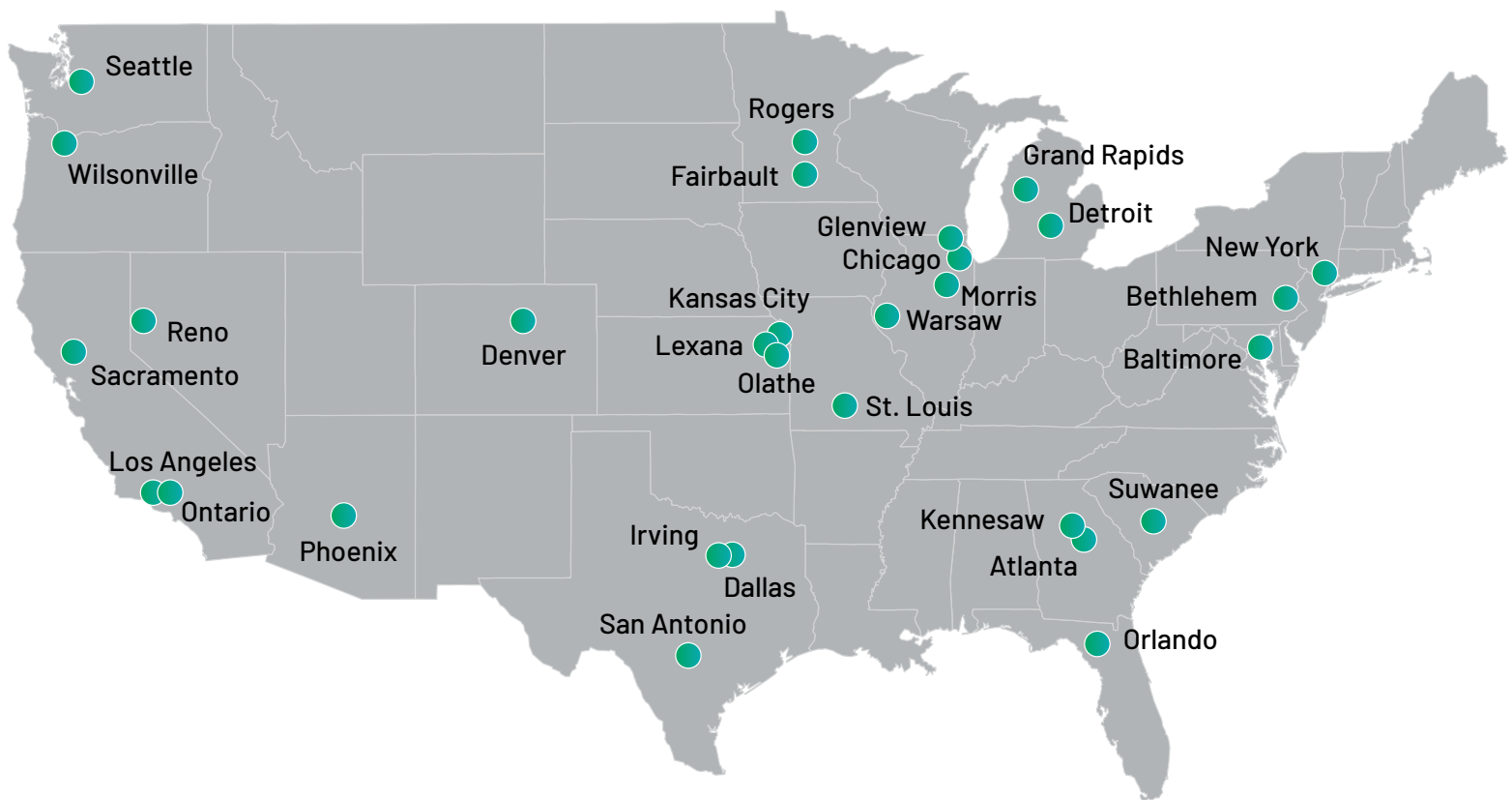

## SERVICED BY



View our full product line  
Structural supports | ANDREW



## ROOFTOP APPLICATIONS

Single and dual penetrating rooftop frame

Single and dual ballasted rooftop frame

Medium capacity roof frames

Rooftop frames - non-penetrating

Rooftop frames - penetrating

Chimney mounts

Radio mounts

Tripod mounts

Universal tripod mounts

Parapet & cube mounts

Wall mounting components

Galvanized cable support components

Wall cable support components

FOR OUR FULL ROOFTOP PRODUCT PORTFOLIO,  
PLEASE VISIT OUR ROOFTOP MOUNTS SITE OR  
FOLLOW THE QR CODE:

[Rooftop mounts](#) | [ANDREW](#)



# HIGH CAPACITY SINGLE AND DUAL PENETRATING ROOFTOP FRAME

## ORDERING INFORMATION

ANDREW now offers a complete line of high-capacity rooftop pipe sector frames designed for increased loading and lower EPA than traditional angle-based rooftop frames. The new RT-Series rooftop mounts are available in both penetrating and non-penetrating frame designs with multiple face size and pipe count options offered as a single part number to simplify ordering.

The RT-Series rooftop mounts all feature heavy duty 2 7/8" OD face pipes and antenna pipes and are rated to both AT&T and TIA-5053 standards with up to 5 antenna pipes (face width dependent). The frame features built-in mechanical adjustments for roof pitch with either single or dual frame versions to maximize load bearing capabilities.

**Single penetrating  
RT series rooftop frame**  
RT-SF10-3-126



**Dual penetrating  
RT series rooftop frame**  
RT-DSF12-3-126



DESCRIPTION	FACE WIDTH	PIPES INCLUDED	PART NUMBER
Single penetrating rooftop frame—meets TIA 5053 standard			
Single penetrating rooftop sector frame	7' face width	(2) 2-7/8" OD X 96" antenna pipes	RT-SF7-2-96
		(2) 2-7/8" OD X 126" antenna pipes	RT-SF7-2-126
		(3) 2-7/8" OD X 96" antenna pipes	RT-SF7-3-96
		(3) 2-7/8" OD X 126" antenna pipes	RT-SF7-3-126
	10' 6" face width	(3) 2-7/8" OD X 96" antenna pipes	RT-SF10-3-96
		(3) 2-7/8" OD X 126" antenna pipes	RT-SF10-3-126
		(4) 2-7/8" OD X 96" antenna pipes	RT-SF10-4-96
		(4) 2-7/8" OD X 126" antenna pipes	RT-SF10-4-126
	12' 6" face width	(3) 2-7/8" OD X 96" antenna pipes	RT-SF12-3-96
		(3) 2-7/8" OD X 126" antenna pipes	RT-SF12-3-126
		(4) 2-7/8" OD X 96" antenna pipes	RT-SF12-4-96
		(4) 2-7/8" OD X 126" antenna pipes	RT-SF12-4-126

DESCRIPTION	FACE WIDTH	PIPES INCLUDED	PART NUMBER
Dual penetrating rooftop frame—meets TIA 5053 standard			
Dual penetrating rooftop sector frame	12' 6" face width	(3) 2-7/8" OD x 96" antenna pipes	RT-DSF12-3-96
		(3) 2-7/8" OD x 126" antenna pipes	RT-DSF12-3-126
		(4) 2-7/8" OD x 96" antenna pipes	RT-DSF12-4-96
		(4) 2-7/8" OD x 126" antenna pipes	RT-DSF12-4-126
	14' 6" face width	(3) 2-7/8" OD x 96" antenna pipes	RT-DSF14-3-96
		(3) 2-7/8" OD x 126" antenna pipes	RT-DSF14-3-126
		(4) 2-7/8" OD x 96" antenna pipes	RT-DSF14-4-96
		(4) 2-7/8" OD x 126" antenna pipes	RT-DSF14-4-126

# HIGH CAPACITY SINGLE AND DUAL BALLASTED ROOFTOP FRAME

## ORDERING INFORMATION

### Single ballasted

#### RT series rooftop frame

RT-NF10-3-96  
(Shown with RT-NFR4 RRU mount)



### Dual ballasted

#### RT series rooftop frame

RT-DF12-4-126



DESCRIPTION	FACE WIDTH	PIPES INCLUDED	PART NUMBER
Single ballasted rooftop frame—meets TIA 5053 standard			
Single ballasted rooftop sector frame	7' face width	(2) 2-7/8" OD x 96" antenna pipes	RT-NF7-2-96
		(2) 2-7/8" OD x 126" antenna pipes	RT-NF7-2-126
		(3) 2-7/8" OD x 96" antenna pipes	RT-NF7-3-96
		(3) 2-7/8" OD x 126" antenna pipes	RT-NF7-3-126
	10' 6" face width	(3) 2-7/8" OD x 96" antenna pipes	RT-NF10-3-96
		(3) 2-7/8" OD x 126" antenna pipes	RT-NF10-3-126
		(4) 2-7/8" OD x 96" antenna pipes	RT-NF10-4-96
		(4) 2-7/8" OD x 126" antenna pipes	RT-NF10-4-126
	12' 6" face width	(3) 2-7/8" OD x 96" antenna pipes	RT-NF12-3-96
		(3) 2-7/8" OD x 126" antenna pipes	RT-NF12-3-126
		(4) 2-7/8" OD x 96" antenna pipes	RT-NF12-4-96
		(4) 2-7/8" OD x 126" antenna pipes	RT-NF12-4-126
RRU mounting kit for RT series ballasted frames	N/A	N/A	RT-NFR4

DESCRIPTION	FACE WIDTH	PIPES INCLUDED	PART NUMBER
Dual ballasted rooftop frame—meets TIA 5053 standard			
Dual ballasted rooftop sector frame	12' 6" face width	(3) 2-7/8" OD x 96" antenna pipes	RT-DF12-3-96
		(3) 2-7/8" OD x 126" antenna pipes	RT-DF12-3-126
		(4) 2-7/8" OD x 96" antenna pipes	RT-DF12-4-96
		(4) 2-7/8" OD x 126" antenna pipes	RT-DF12-4-126
	14' 6" face width	(3) 2-7/8" OD x 96" antenna pipes	RT-DF14-3-96
		(3) 2-7/8" OD x 126" antenna pipes	RT-DF14-3-126
		(4) 2-7/8" OD x 96" antenna pipes	RT-DF14-4-96
		(4) 2-7/8" OD x 126" antenna pipes	RT-DF14-4-126
RRU mounting kit for RT series ballasted frames 1 per frame - Qty 2 required for RT-DF	N/A	N/A	RT-NFR4



# PIM-GUARD SINGLE AND DUAL BALLASTED ROOFTOP FRAMES

## ORDERING INFORMATION

PIM-Guard single ballasted rooftop frames  
RT-NF11-3-120



PIM-Guard dual ballasted rooftop frames  
RT-DF15-4-120



DESCRIPTION	FACE WIDTH	PIPES INCLUDED	PART NUMBER
PIM-Guard single ballasted rooftop frames			
PIM-Guard high capacity non-penetrating roof frame with optimized antenna spacing	11' face width	None	RT-NF11-B
		(3) 2-7/8"OD x 120" antenna pipes	RT-NF11-3-120
	13' face width	None	RT-NF13-B
		(4) 2-7/8"OD x 120" antenna pipes	RT-NF13-4-120
PIM-Guard dual ballasted rooftop frames			
PIM-Guard high capacity dual non-penetrating roof frame with optimized antenna spacing	15' face width	None	RT-DF15-B
		(4) 2-7/8"OD x 120" antenna pipes	RT-DF15-4-120
		(5) 2-7/8"OD x 120" antenna pipes	RT-DF15-5-120

# ROOFTOP FRAMES - NON-PENETRATING

## ORDERING INFORMATION

RF-NL non-penetrating  
angle roof frames



Rooftop frame RRU  
retro kit

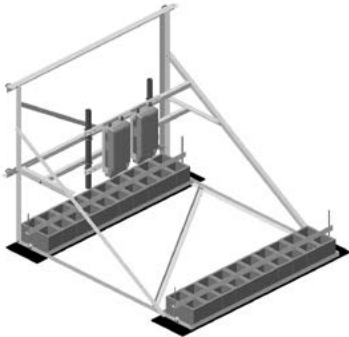

Rooftop microwave dish ballast  
mount system



DESCRIPTION	PART NUMBER
<b>Non-penetrating roof frame, 7' wide (Angle-based design)</b>	
Base frame kit only - 3-1/2" OD pipes ordered separately	RF-NL7-B
Two 3-1/2" OD x 72" pipes	RF-NL7-2-72
Three 3-1/2" OD x 72" pipes	RF-NL7-3-72
Two 3-1/2" OD x 96" pipes	RF-NL7-2-96
Three 3-1/2" OD x 96" pipes	RF-NL7-3-96
<b>Non-penetrating roof frame, 10' -6" (3.2 m) wide (Angle-based design)</b>	
Base frame kit only - 3-1/2" OD pipes ordered separately	RF-NL10-B
Two 3-1/2" OD x 72" pipes	RF-NL10-2-72
Three 3-1/2" OD x 72" pipes	RF-NL10-3-72
Two 3-1/2" OD x 96" pipes	RF-NL10-2-96
Three 3-1/2" OD x 96" pipes	RF-NL10-3-96
<b>Rooftop frame RRU retrofit kit</b>	
RRU retrofit kit	RF-NRK
<b>Rooftop microwave dish ballast mount system</b>	
Three 4.5" OD X 8' supports with 3.5" OD strut support member	RF-MW8-B

# ROOFTOP FRAMES - NON-PENETRATING

## ORDERING INFORMATION

Multi-sector roof frames



Rooftop peak mount



Non-penetrating roof mounts



DESCRIPTION	FACE WIDTH	PIPES INCLUDED	PART NUMBER
<b>Multi-sector roof frames (Ballast tray not included)</b>			
Multi-sector roof frame	10' 6" face width	None	<a href="#">MT-180</a>
Heavy duty multi-sector roof frame		(9) 2-7/8"OD x 96" antenna pipes	<a href="#">MT-180-HD</a>

DESCRIPTION	PART NUMBER
<b>Ballast trays &amp; accessories for multi-sector roof frames</b>	
Ballast tray for multi-sector roof frame (MT-180)	<a href="#">MT-181</a>
Ballast tray for heavy duty multi-sector roof frame (MT-180-HD)	<a href="#">MT-181-HD</a>
Non-penetrating sled tie down kit	<a href="#">RF-TDK</a>
Rubber mat 1/2" x 18" x 48"	<a href="#">MT-F1637</a>

DESCRIPTION	PIPES INCLUDED	PART NUMBER
<b>Non-penetrating roof mounts</b>		
Non-penetrating roof tripod mounts	(1) 1.9"OD x 60" pipe	<a href="#">RM-SM190-60</a>
	(1) 2-3/8"OD x 96" pipe	<a href="#">RM-SM238-60</a>
Non-penetrating peak mount	Order separately (2-3/8" to 4-1/2" OD)	<a href="#">RT-PM-B</a>



# ROOFTOP FRAMES - PENETRATING

## ORDERING INFORMATION

Penetrating rooftop mount

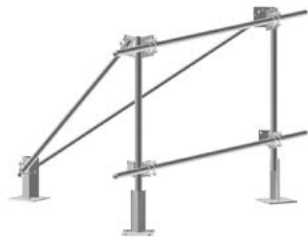

Multi-sector penetrating rooftop mount



DESCRIPTION	PIPES INCLUDED	PART NUMBER
<b>Penetrating rooftop mount</b>		
Rooftop mount - single sector	None	TP-100
<b>Multi-sector penetrating rooftop mount</b>		
Rooftop mount - three sector	None	TP-300

# CHIMNEY MOUNTS

## ORDERING INFORMATION

Chimney mounts



Custom smokestack bracket



DESCRIPTION	CHIMNEY SIZE	PART NUMBER
Chimney mounts		
Round chimney mounts	5' to 6' OD	CM-R56
	6' to 7' OD	CM-R67
	7' to 8' OD	CM-R78
	8' to 9' OD	CM-R89
	9' to 11' OD	CM-R911
	11' to 13' OD	CM-R1113
Square chimney mounts	1' to 10' Face	CM-ST10
DESCRIPTION	ANTENNA PIPE SIZE	PART NUMBER
Slider brackets for chimney mounts (pipe not included)		
Slider brackets for chimney mounts	2-3/8" OD	CM-SB2
	2-7/8" OD	CM-SB3
	3-1/2" OD	CM-SB35
	4-1/2" OD	CM-SB45

DESCRIPTION	PART NUMBER
Chimney mount sector frame mounting bracket	
Enables mounting of sector frames to chimney Requires 2 brackets & 2 chimney mounts per sector frame	760258156-001

# RADIO MOUNTS

## ORDERING INFORMATION

Rooftop RRU mounts



Ground level RRU mounts



DESCRIPTION	PART NUMBER
<b>Rooftop RRU mounts</b>	
Non-penetrating RRU mount (2-pole mounting locations)	RR-TFS
Non-penetrating RRU mount (3-pole mounting locations)	RR-TFS3
<b>Ground level RRU mounts</b>	
Base shoe pipe with 14-1/2" x 14-1/2" base plate	RR-BSP-10
Cluster support bracket - 5 lines	CS-BR
Cluster support bracket - 18 lines	CS-BRL
Ice shield - 24" x 24"	RR-IS24



# TRIPOD MOUNTS

## ORDERING INFORMATION

Rooftop monopole tripods



Hardware kits for tripods

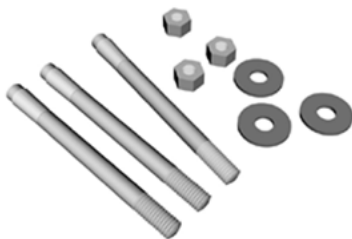

Multi-sector mount for tripods



DESCRIPTION	MAST SIZE	PART NUMBER
Rooftop monopole tripods		
Rooftop tripod assembly	3 meter (9'-9")	RT-MPT-3
	4 meter (13'-1")	RT-MPT-4
	5 meter (16'-5")	RT-MPT-5
	6 meter (19'-8")	RT-MPT-6
	7 meter (22'-11")	RT-MPT-7

DESCRIPTION	PART NUMBER
Hardware kits for tripods	
Anchor set for rooftop tripod mount	MT-421
Thru-bolt set for rooftop tripod mount	MT-422

DESCRIPTION	POLE SIZE	PART NUMBER
Multi-sector mount for tripods		
Three sector clamp on mount	For poles 3-1/2" to 6" OD	SCSMRU-302-M

# UNIVERSAL TRIPOD MOUNTS

## ORDERING INFORMATION

Universal tripod mounts



Non-penetrating roof ballast sled for tripods

TP-G412-72 with MT-416



DESCRIPTION	PIPES INCLUDED	PART NUMBER
Universal tripod mount, 2-7/8" OD	Base only for 2-7/8" or 3-1/2" OD, pipe ordered separately	TP-G300-B
	2-7/8" OD x 96"	TP-G300-96
	2-7/8" OD x 126"	TP-G300-126
Universal tripod mount, 3-1/2" OD	3-1/2" OD x 96"	TP-G312-96
	3-1/2" OD x 126"	TP-G312-126
Universal tripod mount, 4-1/2" OD	Base only for 4-1/2" OD, pipe ordered separately	TP-G412-B
	4-1/2" OD x 96"	TP-G412-96
	4-1/2" OD x 126"	TP-G412-126
	4-1/2" OD x 150"	TP-G412-150
Non-penetrating roof ballast sled for tripods		
Non-penetrating roof sled, tripod mount ordered separately	N/A	MT-416
Rubber mat, 1/2" x 18" x 48", six mats required for ballast tray	N/A	MT-F1637

# PARAPET & CUBE MOUNTS

## ORDERING INFORMATION

Parapet mount



Cube mount



DESCRIPTION	PIPES INCLUDED	PART NUMBER
<b>Parapet mount</b>		
Non-penetrating rooftop parapet mount	(1) 2-3/8"OD x 86" antenna pipe	RF-PM86
<b>Cube mount</b>		
Rooftop cube mount ballast for microwave antennas	Order separately (2-3/8" to 3-1/2" OD)	RT-CUBE-MBASE



# WALL MOUNTING COMPONENTS

## ORDERING INFORMATION

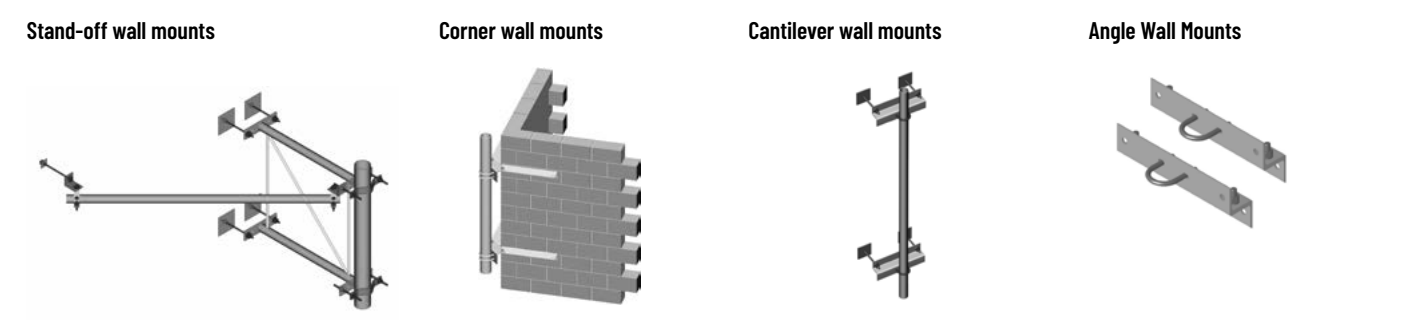

DESCRIPTION	PIPES INCLUDED	PART NUMBER
<b>Stand-off wall mount</b>		
Stand-off wall mount, 36", for solid and hollow walls, includes 72" stiff arm	Pipe ordered separately	DM-300
<b>Corner wall mount</b>		
For 2-3/8" OD pipe	(1) 2-3/8"OD x 96" pipe	CW-M2-96
For 2-7/8" pipe	(1) 2-7/8" OD x 120" pipe	CW-M3-120
For 4-1/2" OD pipe	(1) 4-1/2"OD x 96" pipe	CW-M4-96

DESCRIPTION	STAND-OFF DISTANCE	PIPES INCLUDED	PART NUMBER
<b>Cantilever wall mounts</b>			
Cantilever wall mount for 2-3/8" pipe	2-3/4" stand-off	Order separately - 2-3/8" pipe	MT-250
	5-1/2" stand-off		MT-250L

DESCRIPTION	PIPES INCLUDED	PART NUMBER
<b>Angle wall mounts</b>		
Angle wall mounts for solid or hollow walls	Order separately - 2-3/8" pipe	WMA238
	Order separately - 2-7/8" pipe	WMA300
	Order separately - 3-1/2" pipe	WMA312
	Order separately - 4-1/2" pipe	WMA412
Hollow wall mount kit	N/A	HWK58
Solid wall mount kit		SWK58

# WALL MOUNTING COMPONENTS

## ORDERING INFORMATION

Adjustable wall mounts



Wall mount with stand-off



DESCRIPTION	PART NUMBER
<b>Adjustable wall mounts, 6" stand-off</b>	
For hollow walls, includes backing plates, kit of 2	MT-221
For solid walls, includes wall anchors, kit of 2	MT-222
<b>Adjustable wall mounts, 12" stand-off</b>	
For hollow walls, includes backing plates, kit of 2	MT-221L
For solid walls, includes wall anchors, kit of 2	MT-222L
<b>Optional backing plate</b>	
Backing plate kit, 12" x 12"	MT-223

Note: Pipes and U-bolts sold separately

DESCRIPTION	PIPES INCLUDED	PART NUMBER
<b>Wall mount with 18.6" stand-off</b>		
For solid walls, includes wall anchors	(1) 2-7/8"OD x 150" pipe	WM-ST1812

# GALVANIZED CABLE SUPPORT COMPONENTS

## ORDERING INFORMATION



DESCRIPTION	NUMBER OF HOLES	PART NUMBER
<b>Cable bridge kits</b>		
Self-splicing rooftop cable bridge kits - 12 gauge covers	4 holes	MT-F1542-11
	8 holes	MT-F1543
	12 holes (incl 4 & 8 run covers)	MT-F1595
Self-splicing rooftop cable bridge kits for SnapStak® snap-in hangers	4 holes	RT-CB4D
	8 holes	RT-CB8D
	12 holes	RT-CB12D
DESCRIPTION	NUMBER OF CABLE RUNS	PART NUMBER
<b>Cable bridge kit accessories</b>		
Adjustable splice for roof-top coaxial cable bridge kits	4 runs	MT-F1573-11
	8 runs	MT-F1574
	12 runs	MT-F1597
Extension kit for roof-top coaxial cable bridge kits	Extension kit for 4 runs	MT-F1703
	Extension kit for 8 runs	MT-F1704
Rooftop cable tray step over	N/A	RT-ST
PVC roof sleeper	No holes - 8' long	MT-F1585
Rubber sleeper pad	1/4" x 4" x 10' roll	CT-P4
	1/4" x 4" x 50' roll	CT-P50

DESCRIPTION	PART NUMBER
<b>Rooftop hood entry</b>	
Rooftop hood entry kit - cable entry ports not included	MT-365G

# WALL CABLE SUPPORT COMPONENTS

## ORDERING INFORMATION

Wall cable support kits

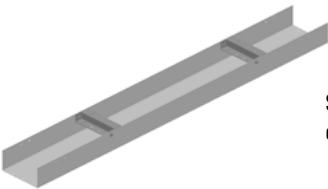

Splice kits for wall cable supports



Wall mount brackets for wall cable supports



Splice kits for wall cable supports

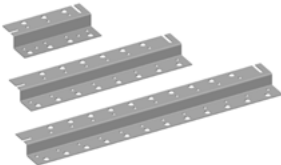

DESCRIPTION	NUMBER OF CABLE RUNS	PART NUMBER
Wall cable support kits		
Wall cable support kits	4 runs	MT-F1589
	8 runs	MT-F1590
	12 runs, self-splicing	MT-F1591
Splice kits for wall cable supports	4 runs	MT-F1607
	8 runs	MT-F1608
Wall mount brackets for wall cable supports	4 runs	MT-F1586
	8 runs	MT-F1587
	12 runs	MT-F1588
Horizontal Z-brackets	11" wide for 7 runs	ZB-H4
	23" wide for 14 runs	ZB-H8
	35" wide for 22 runs	ZB-H12
Z-bracket wall support covers for SnapStak® snap-in hangers (Z-brackets ordered separately - qty 3 required)	4-hole cover	WC-SC4D
	8-hole cover	WC-SC8D
	12-hole cover	WC-SC12D



## WATER TOWER APPLICATIONS

Wall cable support components

Stackable water tower pod mounts

Water tower sector frames

Water tower mounts

FOR OUR FULL PRODUCT PORTFOLIO, PLEASE  
VISIT OUR WATER TOWER MOUNTS SITE OR  
FOLLOW THE QR CODE:

[Water Tower | ANDREW](#)



# STACKABLE WATER TOWER POD MOUNTS

## ORDERING INFORMATION

Base kit



Base kit with platform



DESCRIPTION	FACE WIDTH	PIPES INCLUDED	PART NUMBER
Water tower pod mounts			
Base kit only - platform & pipes ordered separately	N/A	None	WT-SPM-B
Base kit with platform - pipes ordered separately	12'-6" wide face	None	WT-SPM12-B
Pod base, 3-sector platform, & antenna pipes		(9) 2-3/8"OD x 96" antenna pipes	WT-SPM12-9-96
		(9) 2-3/8"OD x 126" antenna pipes	WT-SPM12-9-126
		(12) 2-3/8"OD x 96" antenna pipes	WT-SPM12-12-96
		(12) 2-3/8"OD x 126" antenna pipes	WT-SPM12-12-126
Base Kit with Platform - Pipes ordered separately	14'-6" wide face	None	WT-SPM14-B
Pod Base, 3-Sector Platform, & Antenna Pipes		(9) 2-3/8"OD x 96" antenna pipes	WT-SPM14-9-96
		(9) 2-3/8"OD x 126" antenna pipes	WT-SPM14-9-126
		(12) 2-3/8"OD x 96" antenna pipes	WT-SPM14-12-96
		(12) 2-3/8"OD x 126" antenna pipes	WT-SPM14-12-126

# STACKABLE WATER TOWER POD MOUNTS

## ORDERING INFORMATION

Mini monopole for pod mounts



Extension for pod mounts



DESCRIPTION	MONOPOLE HEIGHT	PART NUMBER
Mini monopole for pod mounts		
Mini monopole for stackable pod mounts	7' tall	WT-MMP-7
	10' tall	WT-MMP-10
	16' tall	WT-MMP
Extension for pod mounts		
Stackable pod mount extension	1' tall	WT-SPM-E1

# WATER TOWER SECTOR FRAMES

## ORDERING INFORMATION

3-sector water tower rooftop frames

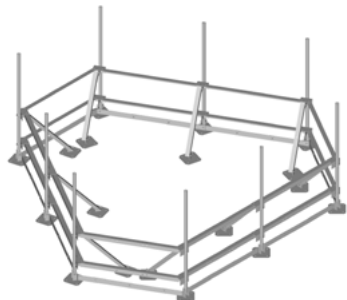

Single sector water tower rooftop frames



Water tower sector frame extensions



DESCRIPTION	SIZE	PIPES INCLUDED	PART NUMBER
Water tower pod mounts			
3-sector water tower rooftop frames	12' face width	(9) 2-3/8"OD x 96" antenna pipes	WT-RTA12-9-96
		(12) 2-3/8"OD x 96" antenna pipes	WT-RTA12-12-96
	14' face width	(9) 2-3/8"OD x 96" antenna pipes	WT-RTA14-9-96
		(12) 2-3/8"OD x 96" antenna pipes	WT-RTA14-12-96
Single sector water tower rooftop frames	12' face width	(3) 2-3/8"OD x 96" antenna pipes	WT-SMA12-3-96
		(4) 2-3/8"OD x 96" antenna pipes	WT-SMA12-4-96
	14' face width	(3) 2-3/8"OD x 96" antenna pipes	WT-SMA14-3-96
		(4) 2-3/8"OD x 96" antenna pipes	WT-SMA14-4-96
Water tower sector frame extensions	6' long extension	(1) 2-3/8"OD x 96" antenna pipes	WT-RTA6-96E
	7' long extension	(1) 2-3/8"OD x 96" antenna pipes	WT-RTA7-96E

# WATER TOWER MOUNTS

## ORDERING INFORMATION

Water tower tripod mounts



Water tower handrail mounts

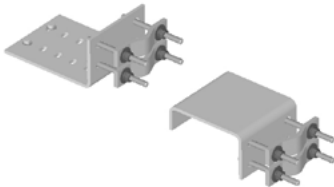

Water tower mid-span mounts

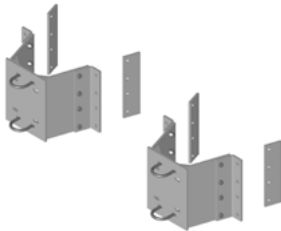

DESCRIPTION	PIPES INCLUDED	PART NUMBER
<b>Water tower tripod mounts</b>		
Water tower tripod mounts	(1) 3-1/2"OD x 96" mount pipe	WT-TMA35-96
	(1) 4-1/2"OD x 96" mount pipe	WT-TMA45-96
<b>Water tower handrail mounts</b>		
Water tower handrail mount for 2-3/8" OD pipe	None	WT-HRM2-B
	(1) 2-3/8" OD x 72" mount pipe	WT-HRM2-72
	(1) 2-3/8" OD x 96" mount pipe	WT-HRM2-96
	(1) 2-3/8" OD x 126" mount pipe	WT-HRM2-126
Universal handrail mount for 2-3/8" to 4-1/2" pipe	None	WT-HRM-U
<b>Water tower mid-span mounts</b>		
Mis-span mount for 2-3/8" pipe	None	WT-MSM2-B
Mis-span mount for 2-7/8" pipe	None	WT-MSM3-B
Mis-span mount for 3-1/2" pipe	None	WT-MSM35-B
Mis-span mount for 4-1/2" pipe	None	WT-MSM4-B

# WATER TOWER CABLE SUPPORT COMPONENTS

## ORDERING INFORMATION

Water tower cable support stand-off brackets

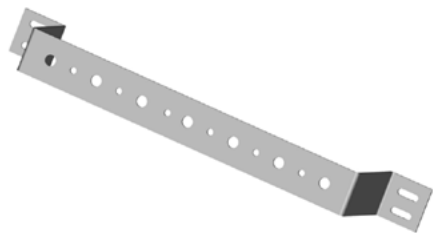

DESCRIPTION	NUMBER OF CABLE RUNS	PART NUMBER
Water tower cable support stand-off brackets		
Water tower cable support stand-off brackets	2 runs	VC-WGSO-2
	4 runs	VC-WGSO-4
	7 runs	VC-WGSO-7
	12 runs	VC-WGSO-12



Since 1937, ANDREW, an Amphenol company, has driven the evolution of wireless technology. Trusted by mobile network operators and enterprises globally, we work closely with our customers to deliver innovative solutions that enhance connectivity experiences both outdoors and indoors. Our dedicated global team is committed to advancing the industry, fueled by the vision that a better-connected future is possible.



---

**ANDREW.COM**

Visit our website or contact your local ANDREW representative for more information.

©2025 Amphenol Corporation. All rights reserved. Amphenol and ANDREW are registered trademarks of Amphenol and/or its affiliates in the U.S. and other countries. All product names, trademarks and registered trademarks are property of their respective owners. CO-119678.1-EN (05/25)